



 **MAROTTA®**

MV602L SOLENOID VALVE | DATASHEET



Your
Success is
OUR Mission

WWW.MAROTTA.COM

TECHNOLOGY OVERVIEW

Marotta's miniature high pressure, magnetically latching, solenoid valve delivers maximum performance while requiring minimal power, physical envelope and weight. This highly optimized all-welded design can be used in a wide variety of applications, from Xenon Feed Systems to Gaseous Oxygen Feed systems to Micro Propulsion Systems.



TECHNICAL DATA

PARAMETER	MV602L
Inlet Pressure	2900 psi (200 Bar)
Proof	4350 psi (300 Bar)
Burst	7240 psi (500 Bar)
Operating Temperature	- 13°F to 122°F (- 25°C to 50°C)
Non-Operating Temperature	- 22°F to 122°F (- 30°C to 50°C)
Internal Leakage	<1 x 10 ⁻⁴ sccs GHe
External Leakage	≤1 x 10 ⁻⁶ sccs GHe
Flow Capacity	ESEOD 0.014" Cd = 0.6

PARAMETER	MV602L
Service	Nitrogen, Inert Gas
Operating Voltage	22 to 32 VDC
Power, Peak	8 Watts
Response Time	30 milliseconds
Duty	200 milliseconds
Operating Mode	Magnetically Latching
End Connections	0.25" (0.635 cm) stub tube
Stub Tube Material	CRES 304L 316L Condition A
Weight	0.22 lbs (100 grams)

Note: The listed data does not represent the design limitations of the device

INSTALLATION DIMENSIONS

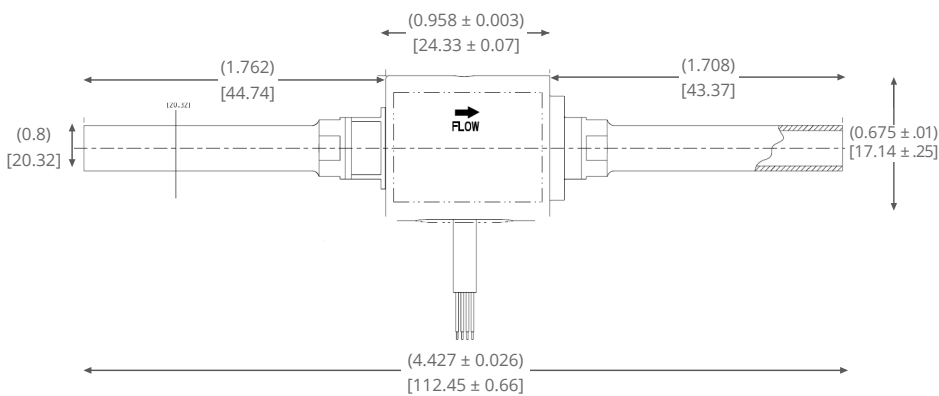

OPTIONS

- ▶ Swagelock fittings, male flared tubes fitting
- ▶ End connections: weldable tube stubs
- ▶ Electrical connector on pigtail end
- ▶ Inlet & outlet filtration
- ▶ Pigtail length
- ▶ Thruster nozzle on outlet

MAROTTA CONTROLS PROPRIETARY

The information contained in this document is Marotta Controls Proprietary. This notice shall appear in any such reproduction, in whole or in part.